



{ 7/2 Oat 10" S. 18 1/2 W. .30 lin/4  
 " " 12" S. 49 20 E. .27 "  
 { 6 W. Oat 6" N. 21 1/2 W. .47 "  
 " " 6" N. 18 E. .40 .

Lot 3 divided into timber lots as per plat filed in the  
 Register of Deeds office. stakes at corners and lines blazed

SURVEY No. 4

Section 31.

Town 108.

Range 40.

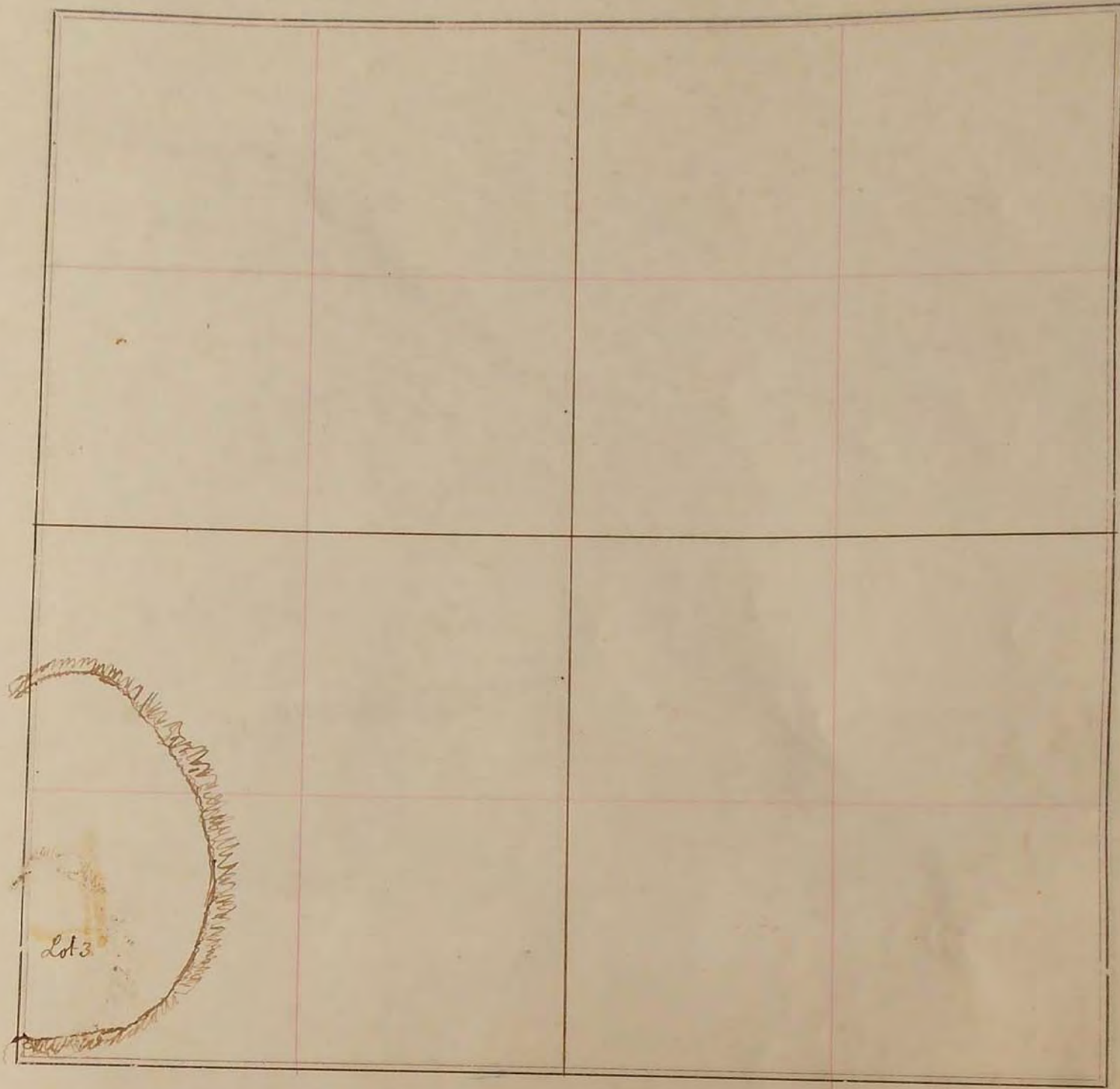

FIELD NOTES.

Lot 3, Divided into timber lots as per plat filed  
 in Register of Deeds Office. Stakes at corners  
 and lines blazed.

SURVEY No. 2112

Section 31

Town 108

Range 40

May 31.

1876

2.000 acres 37

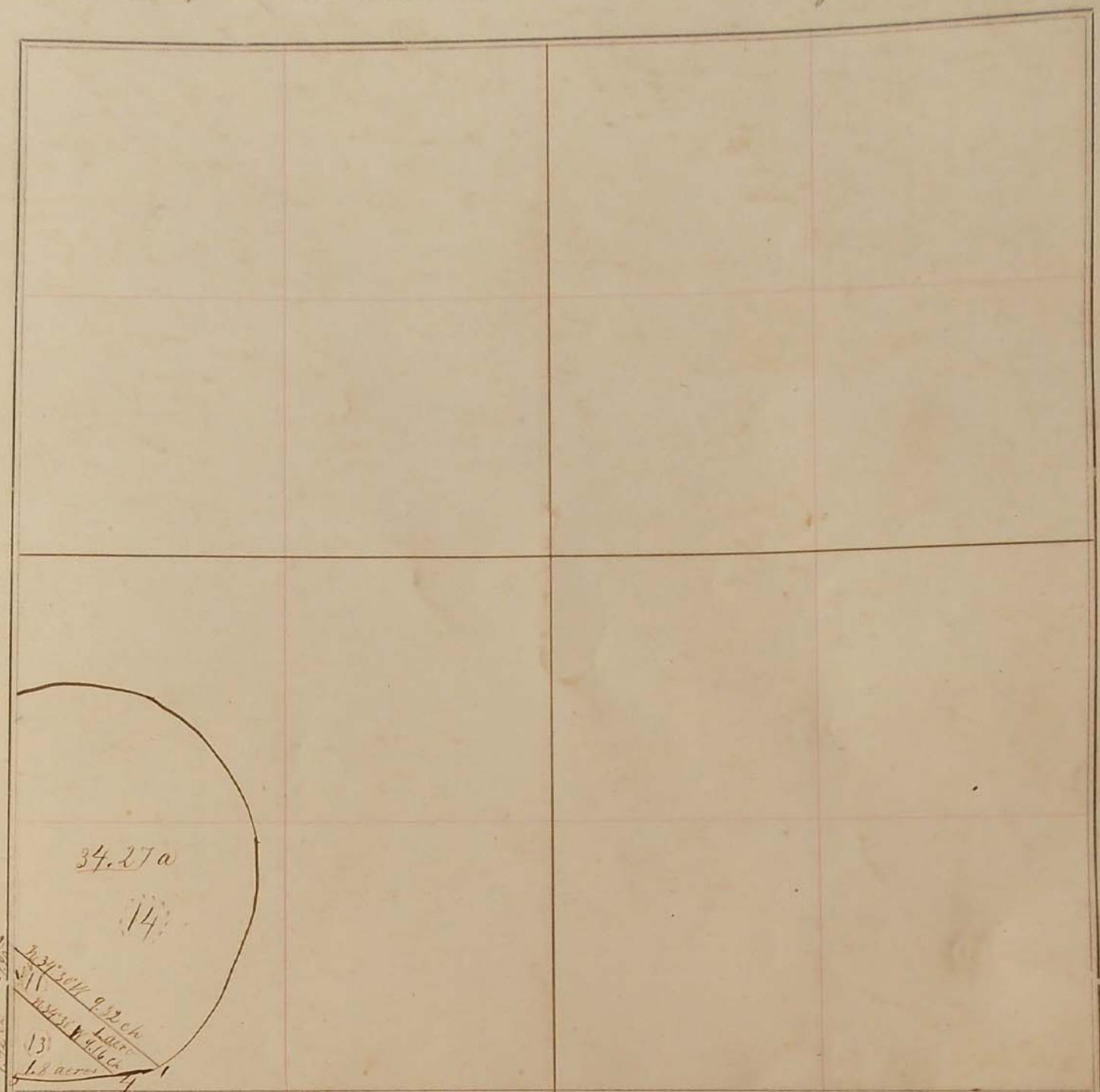

FIELD NOTES.

Bearing Trees.

- 1. W. Ash 2 in dia bears N 45° W .16 ch
- 2. Water Elm 30 in dia bears S 20° E .200 ch
- 3. Iron Wood 6 in dia bears N 3° W .16 ch
- 4. Elm 6 in dia on line N 34° 30' W .10 ch
- 5. Government meadow post
- 61 Post W. Ash 20 in dia North 15 chains
- W. Ash 4 in dia (on stump) 12 in dia S 52° E .21 ch
- 62 Post B.J. Thornapple 10 in dia N 52° E .09 ch
- W. Ash 1 in dia 32 1/2 in dia 30 chains

- Field Notes for Sect. 3107. R41 continued from p. 32
- 49. W. Ash for corner 2 in dia
- B.J. Oak N 45° E 30 in dia 12 chains
- 50. Post
- 51. Post
- 52. Post B.J. W. Ash South 2 in dia .16 ch
- 53. W. Ash for corner in clump of 7 Ash trees
- 54. Post W. Ash 2 in dia .10 ch
- 55. 56. 57. Posts
- 58. Basswood for corner B.J. Oak S 89° W 20 in dia .17 ch
- 59. Iron Wood for corner 4 in dia
- B.J. Ironwood S 45° E 12 in dia .11 ch
- 60. Post for corner W. Ash N 32° W 10 in dia .20 ch
- 61. Post for corner
- B.J. Oak 5 in dia N 35° W .06 ch